

Threaded Version

Sizes DN15, DN20 and DN25 - Type EFK-SC & EFG-SC

DESCRIPTION

The new EBE ECOFLOW venturi orifice steam trap range is designed to meet the rigorous requirements demanded by today's industrial plant users. Developed on a modular concept, the trap encompasses a wide range of capacities. From minimal condensate flow requirements, on line drainage and trace heating systems, through to the high flow volumes and variable loads of process heating applications. The trap's unique innovative design allows for both these conditions to be serviced within the same threaded or socket welded body.

The new EBE ECOFLOW threaded or socket welded trap incorporates the first venturi steam trap design that is integral with the cast housing. Delivering permanent solutions for all steam trapping requirements. The venturi orifice technology forms part of your total steam system pipework. With no moving parts it is a permanent part of the steam system and will never need replacement.

FEATURES

- Unique modular design for low and high condensate flow
- Multiple nozzle configurations designed for optimum efficiency at operating point.
- Fully cast housing with optional BSP threaded or socket weld connections
- Flexible filtration options, increased secondary filtration available for contaminated systems
- Graphite seals metal bonded and fully encapsulated to eliminate leakages
- All BSP thread dimensions in accordance with ISO 7-1:1994
- In line constructions allows for removal and cleaning of filters and nozzles

ASSEMBLY

PART NO. DESCRIPTION

See table page two **Threaded or socket welded body**
 ASTM 304 SS (DIN 1.4308Equivalent)
 ASTM 316SS (DIN 1.4408 equivalent)
 Sizes DN15 and DN20

1140 Filter Cap
 ASTM 304 SS (DIN 1.4308Equivalent)

1150 Top Cap (EFK)

1160 Top Cap (EFG)
 ASTM 304 SS (DIN 1.4308Equivalent)

1190 Principal Filter
 400 or 800 Micron SS reinforced 304 SS
 (DIN 1.4301Equivalent)

1200 Strainer Gasket
 Metal reinforced graphite

1210 Top Cap Gasket
 Metal reinforced graphite

1220 Variable Nozzle Gasket (EFK)

1230 Variable Nozzle Gasket (EFG)
 Metal reinforced graphite

1240 Variable Nozzle (EFK)

1250 Variable Nozzle (EFG)
 ASTM 304 SS (DIN 1.4404 Equivalent)

1260 Top Cap retaining screws (EFK)
 M6 x 16 hex socket heads (ISO 4762 / DIN912)

1270 Top Cap retaining screws (EFG)
 M6 x 25 hex socket heads (ISO 4762 / DIN912)

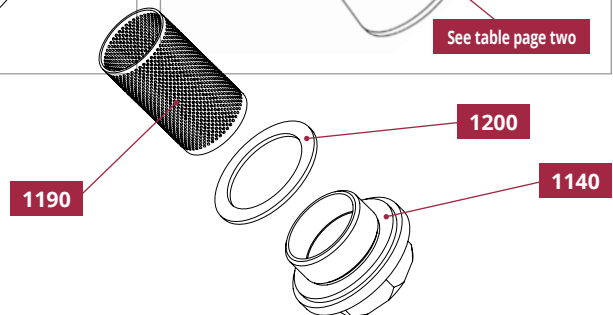
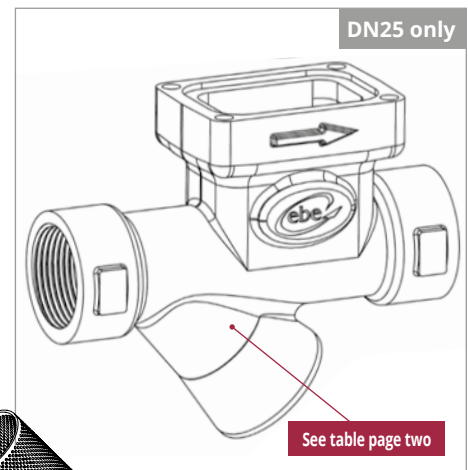
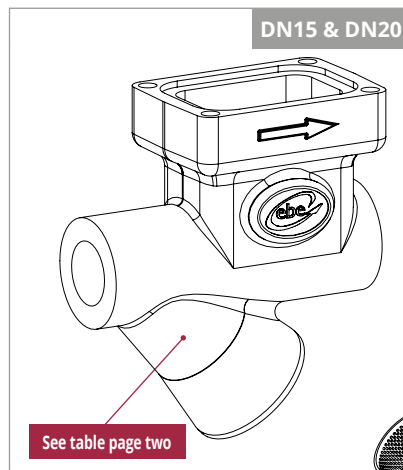
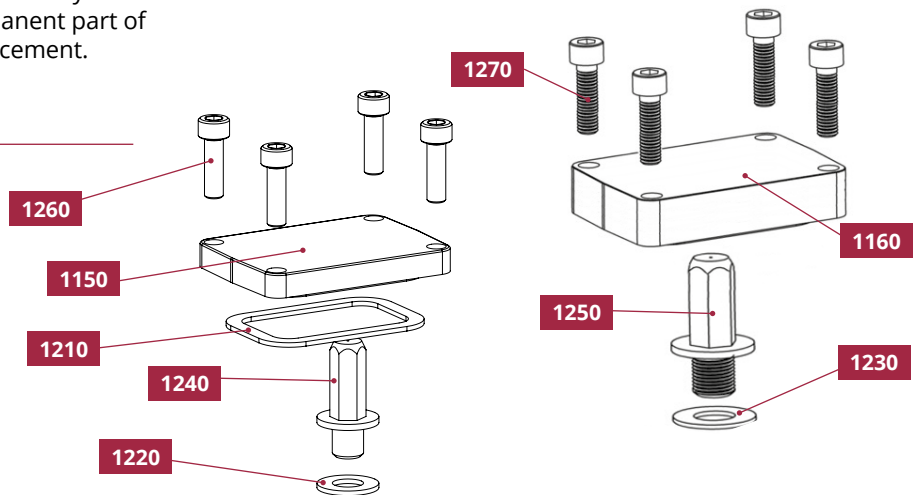

Threaded Version

Sizes DN15, DN20 and DN25 - Type EFK-SC & EFG-SC *continued*

DIMENSIONS AND WEIGHTS

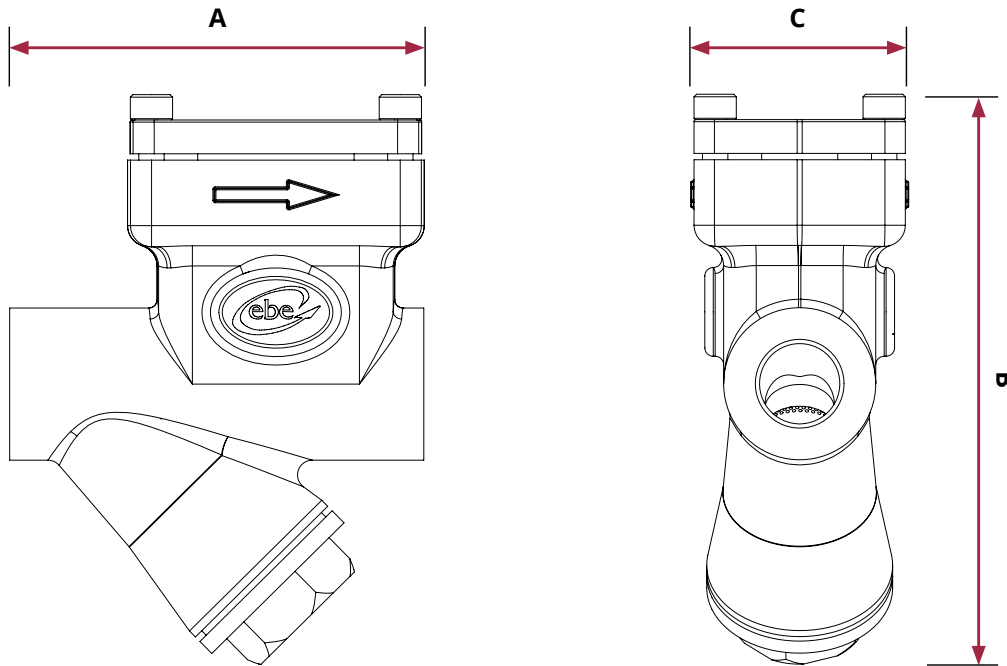

Type EFK-SC						
Part No.	Size	Connection	A mm	B mm	C mm	Approx Weight
1081	DN15	Flange Form B PN40	98	130	50	1.8 kg
1111	DN20	Flange Form B PN40	98	130	50	1.8 kg
1130	DN25	1" BSP or socket weld	130	130	50	2.0 kg

SIZES AND CONNECTIONS

BSP ½" (DN15); BSP ¾" (DN20); BSP 1" (DN25)
 Socket weld ends DN15, DN20, DN25
 Other socket connections available on request at additional cost

PRESSURE / TEMPERATURE LIMITS

PMA (Maximum Allowable Pressure)	90 bar g
TMA (Maximum Allowable Temperature)	500°C
PMO (Maximum Operating Pressure)	75 bar g
TMO (Maximum Operating Temperature)	450°C
Cold hydraulic test pressure	100 bar g

CERTIFICATION

- All steam traps carry a ten year performance guarantee
- Material inspection Certificate, in accordance to DIN EN 10204: 3:1, available on request
- Pressure test certificates, in accordance to European Pressure Equipment Directive 2014/68/EU, available on request

All certification delivered at additional cost
 Certification requirements to be stated at time of order

We reserve the right to make technical and design changes to the descriptions and specifications in our Data Sheets, catalogues or similar sales documents in the same or better quality and we may exchange parts and components against such of same or better technical standards; for the Customer no rights will arise resulting from this conduct.

Type EFG-SC						
Part No.	Size	Connection	A mm	B mm	C mm	Approx Weight
1070	DN15	Flange Form B PN40	98	145	50	2.0 kg
1090	DN20	Flange Form B PN40	98	145	50	2.0 kg
1120	DN25	1" BSP or socket weld	130	145	50	2.2 kg

PERFORMANCE DATA

Steam trap body	Max flow rate	
	@ 10 bar	@ 20 bar
EFK (<i>drip leg/trace heating</i>)	40kg/hr	55kg/hr
EFK (<i>Low flow process</i>)	1000kg/hr	1400kg/hr
EFG (<i>High flow process</i>)	11500kg/hr	15500kg/hr

- Note:**
- Pressures above 20 bar, duty conditions are available upon request

Optional extras

ISOJAG Nomex material insulation jacket. See separate technical Data Sheet for specifications